

Recommendations for Parklet Pilot Program

Presentation to City Council

8/18/15

R. Holmlund

Refresher – What is a parklet?



Presented to City Council
6/2/15

Robert Holmlund and Lisa Savage

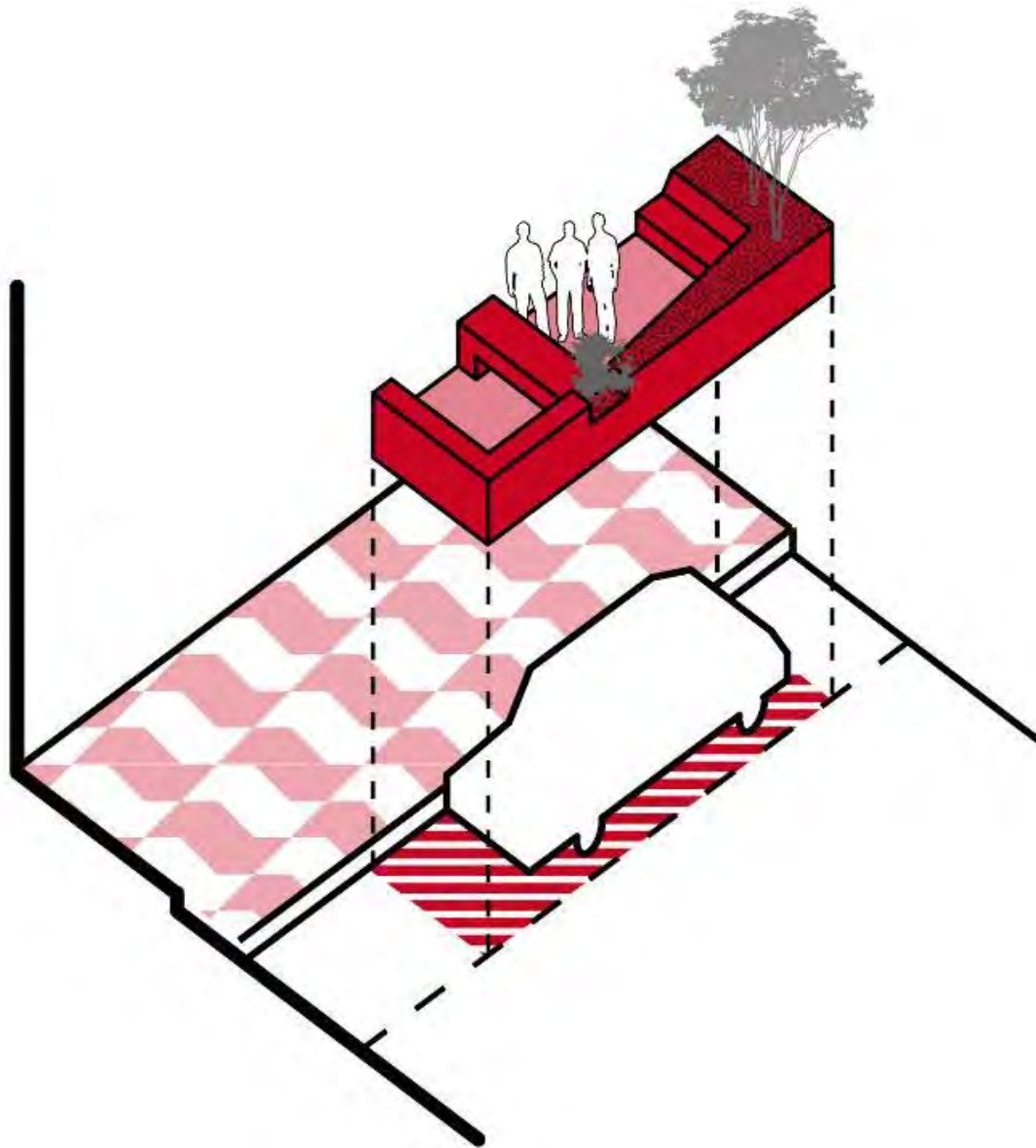







Squat o Gobbie
ONIONS & CRESS

ARTOUR

MAX
SPORT

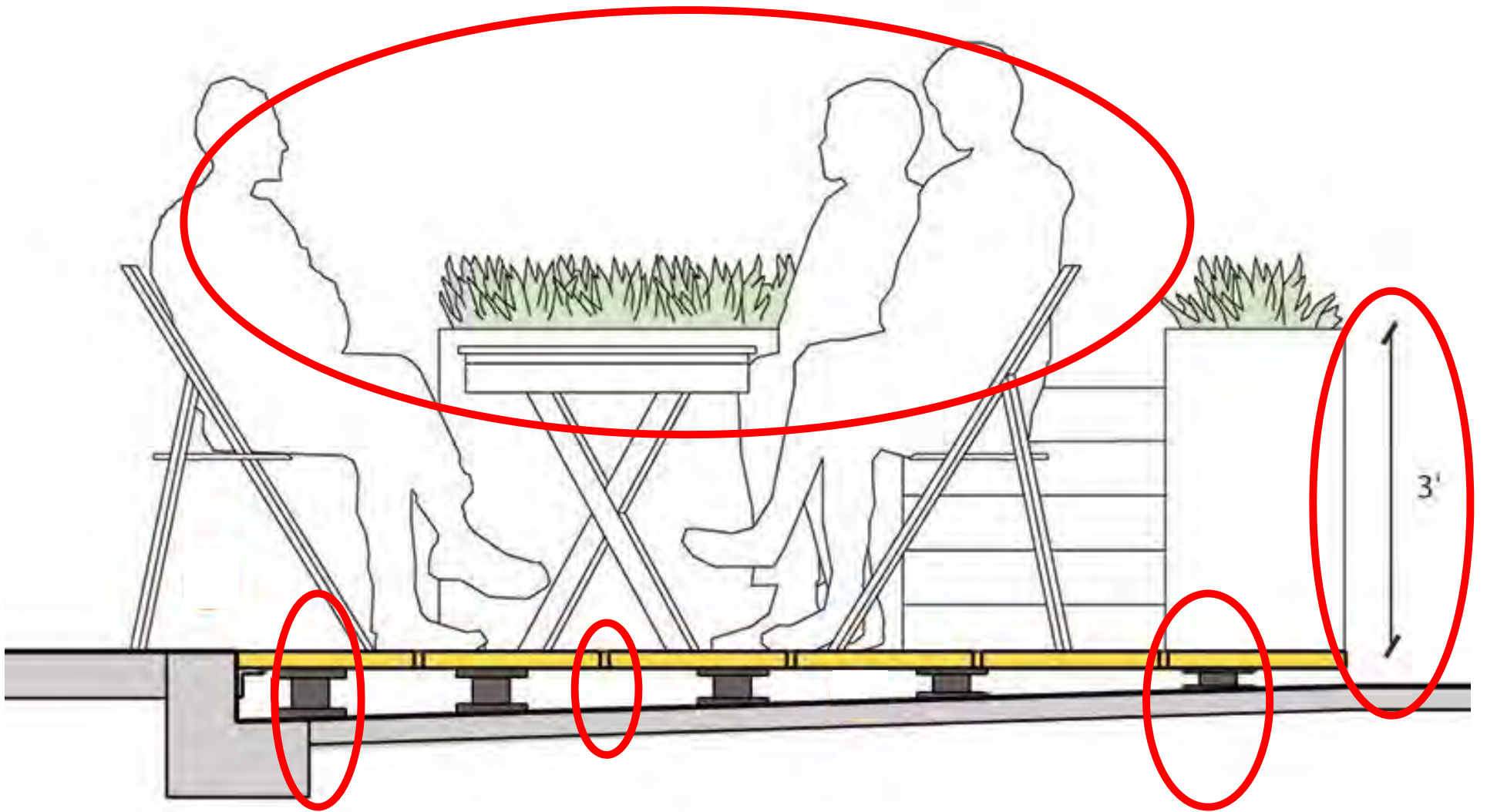

Pilot Program

- Are parklet's appropriate for Eureka?
- How should we customize the required design standards?
- What is the appropriate stormwater design for Eureka?
- How do parklets affect traffic?
- How do parklets affect parking?
- What is the neighborhood sentiment?
- Do parklet create an increase in business ?
- Other considerations

The Proposed Parklets

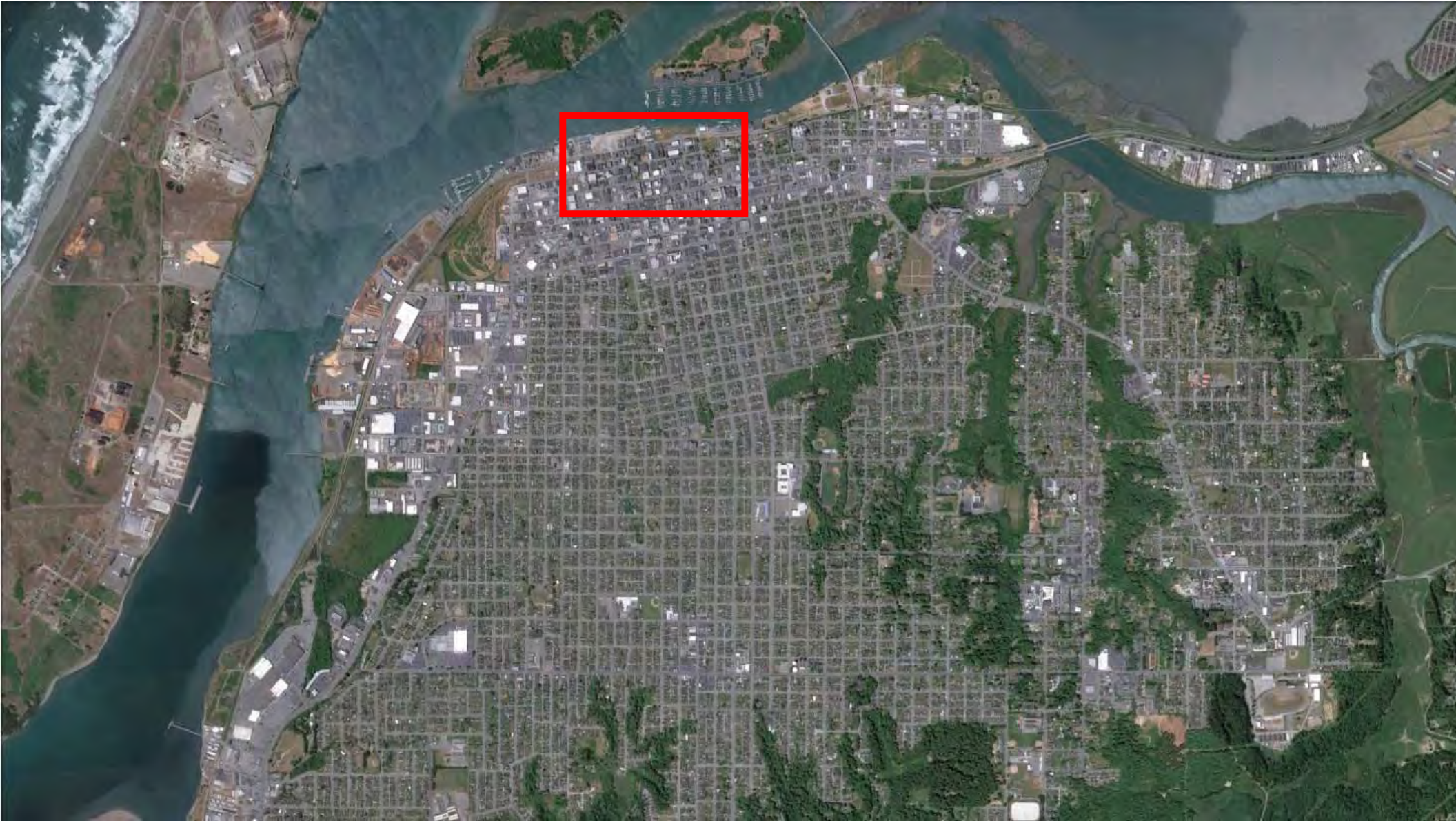





First Street

F Street

G Street

D Street

Second Street

E Street

Carson Block
Third Street

4

2

3

1

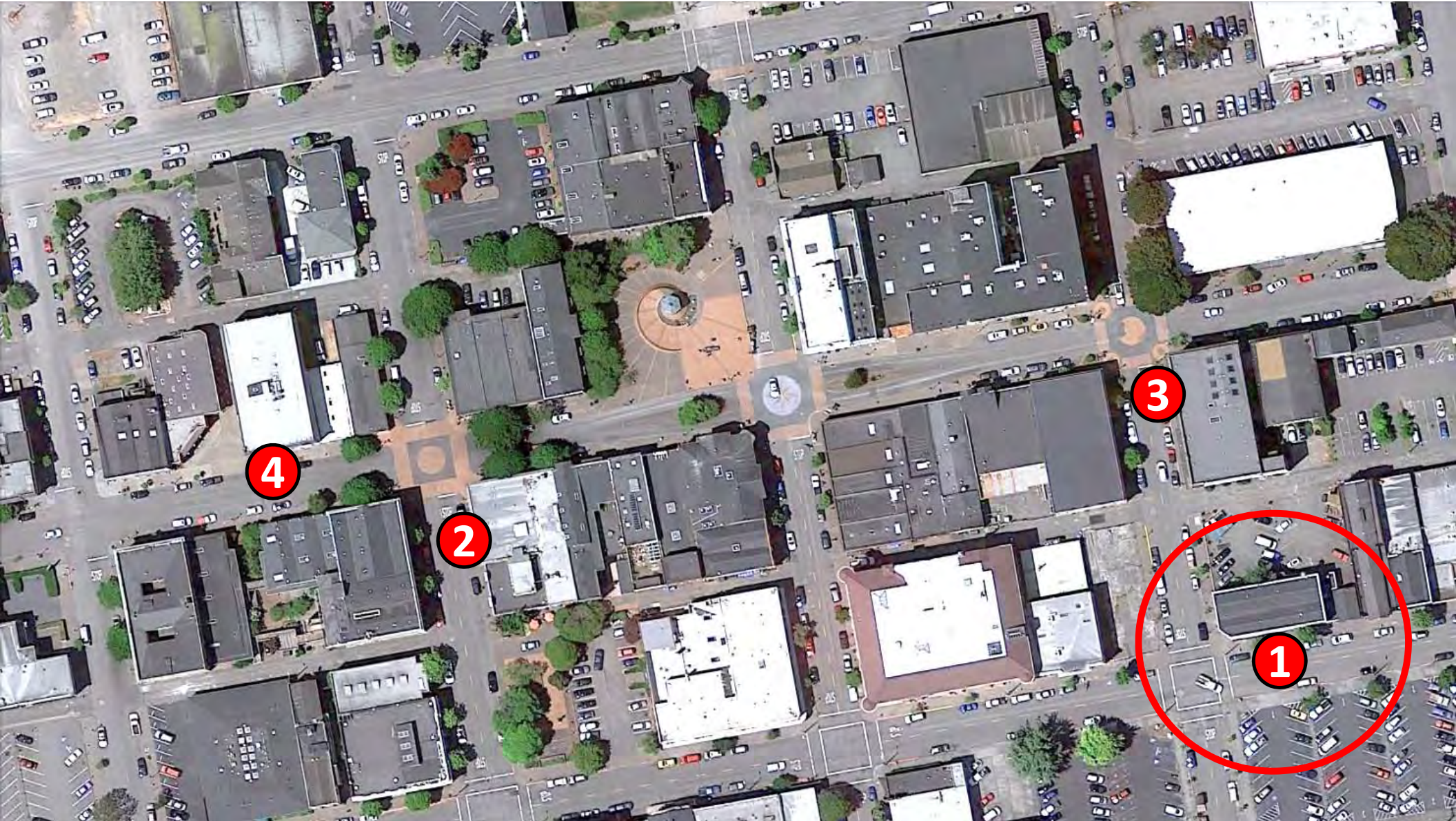

3

1

2

4



Carson
Block

G Street

Third Street

1

A Taste of Bim



ADVANTEGES

- Numbered Street
- Sunny spot
- Across street from city lot
- Lunch and dinner dinning
- Wide sidewalks
- Visible from inside business
- Busy street
- Street tree
- New business
- Not corner/ not mid-block
- “Slower” part of Old Town
- Built-in lighting/landscaping
- Letters of support

A Taste of Bim

CARIBBEAN BISTRO • 613 3RD ST. EUREKA CA

Proposal for Eureka
Parklet Pilot Program



A Taste of Bim



PARKLET SOUTH ELEVATION

ELEVATION DESIGN

K. BOODJEH ARCHITECTS



PARKLET SECTION



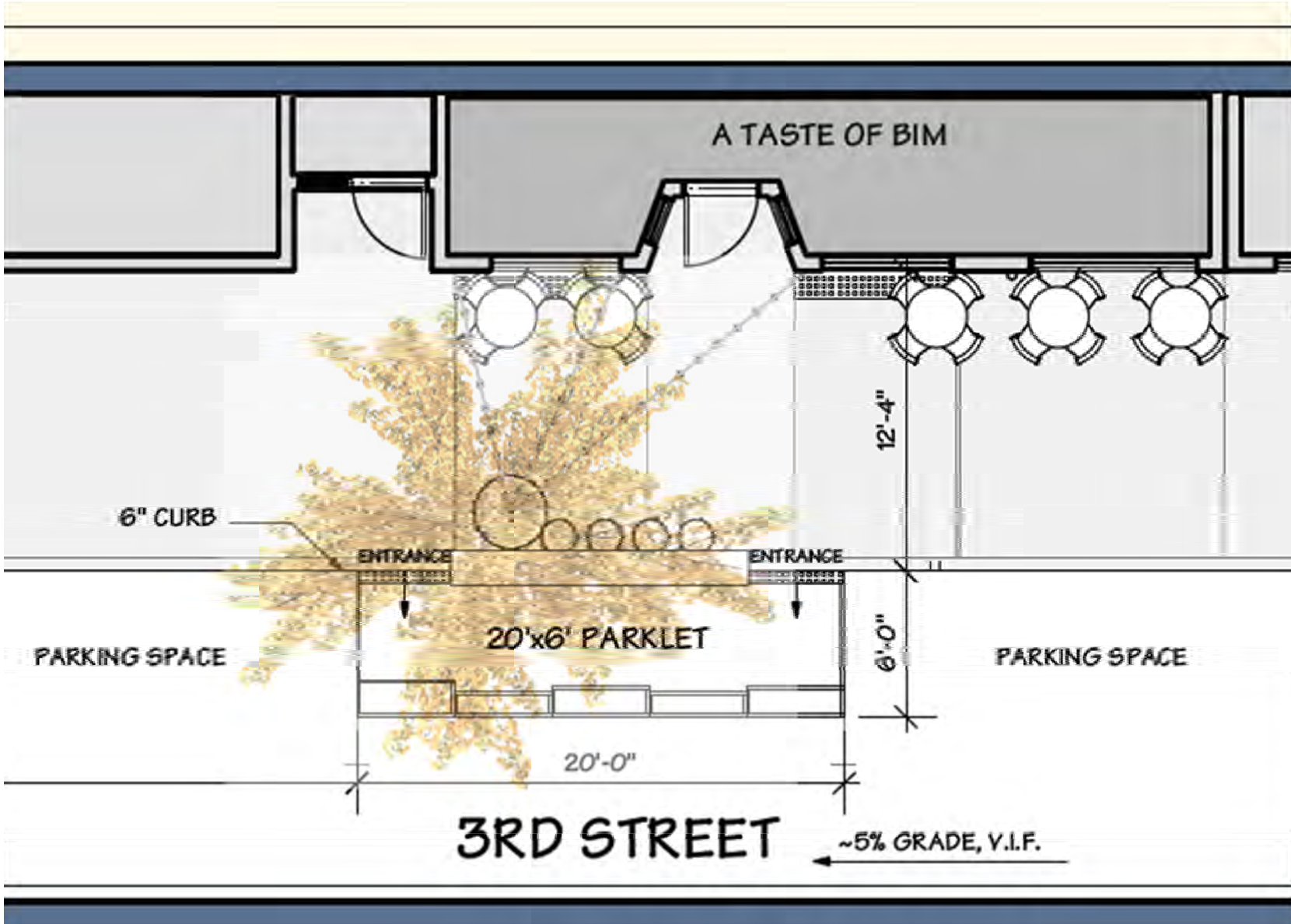



Landscaping
Design by Miller
Farms Nursery



CHERRY COLA
CORAL BELLS



Attracts Hummingbirds
Full-Sun Color
Attracts Birds
Tolerates Footage

Perennial

SILVER
DUST



DUSTY
MILLER

Silver-white foliage,
dwarf. Use in borders,
pots.

HOW TO GROW:
Plant in sun or part sun
8" (20 cm) apart. Grows

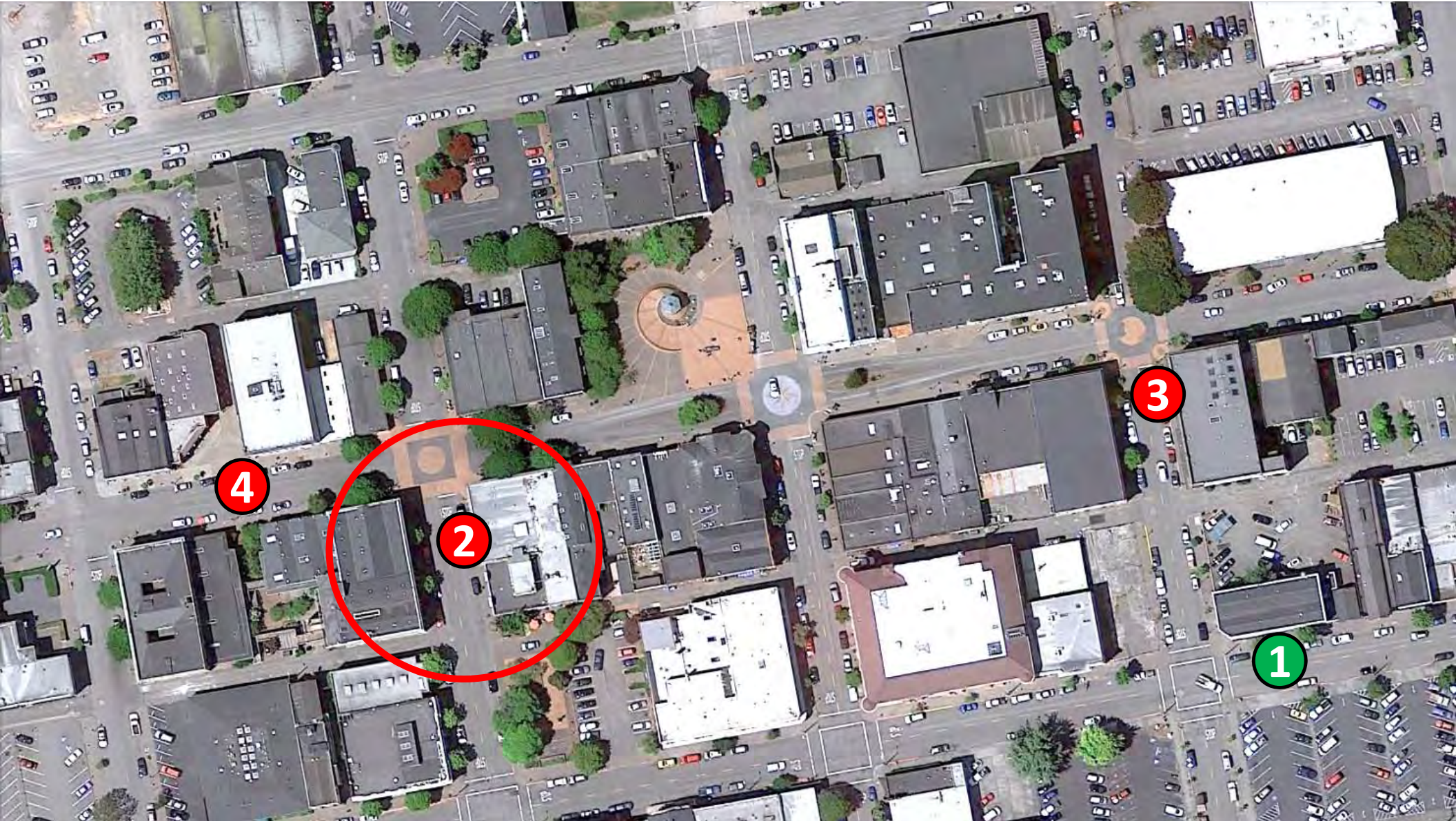

1

3

2

4



Second Street

2

E Street

Carson Block

Ramones



ADVANTEGES

- Lettered Street
- Less sunny spot
- Mid block
- Connects to green curb
- Primarily morning/lunch
- Wide sidewalks
- Visible from inside business
- Built-in lighting/landscaping
- Bike rack

Idea Photos:



Planter style and width



Bicycle rack style



Colorful bistro seating



Railing cap



Seat style (but without planter in seat)



Example of skirting board and drainage

JULY 2015

PLAN VIEW - PROPOSED PARKLET LOCATION (FOR RAMONE'S BAKERY)

SITE ADDRESS: 209 E STREET
EUREKA, CA 95501

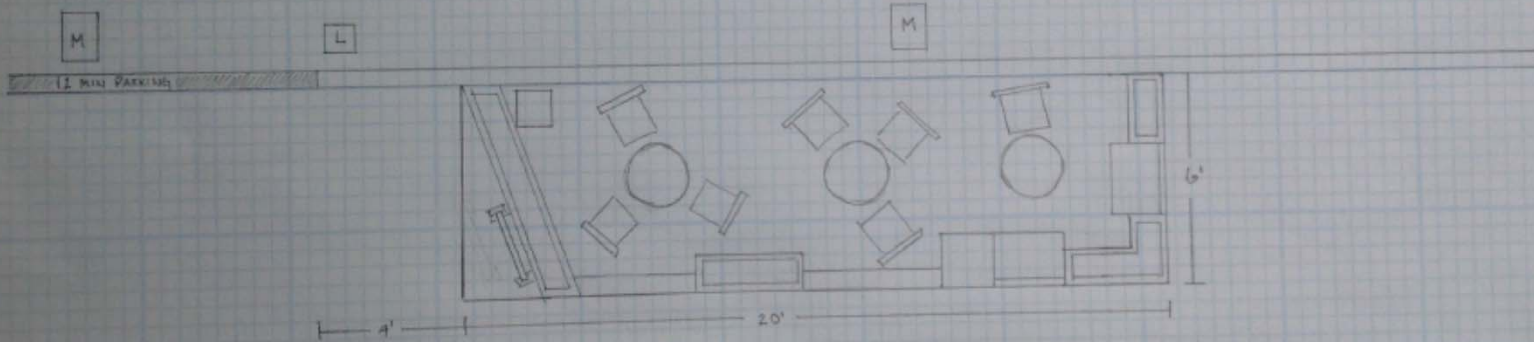

ATTACHMENT #B



L

M

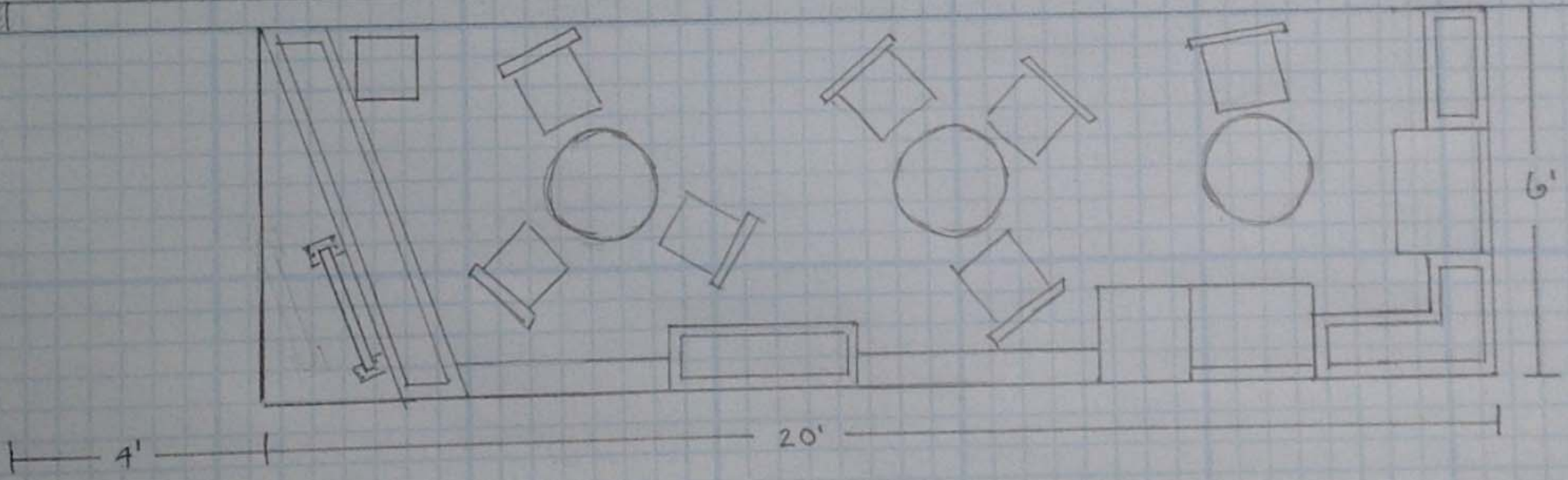

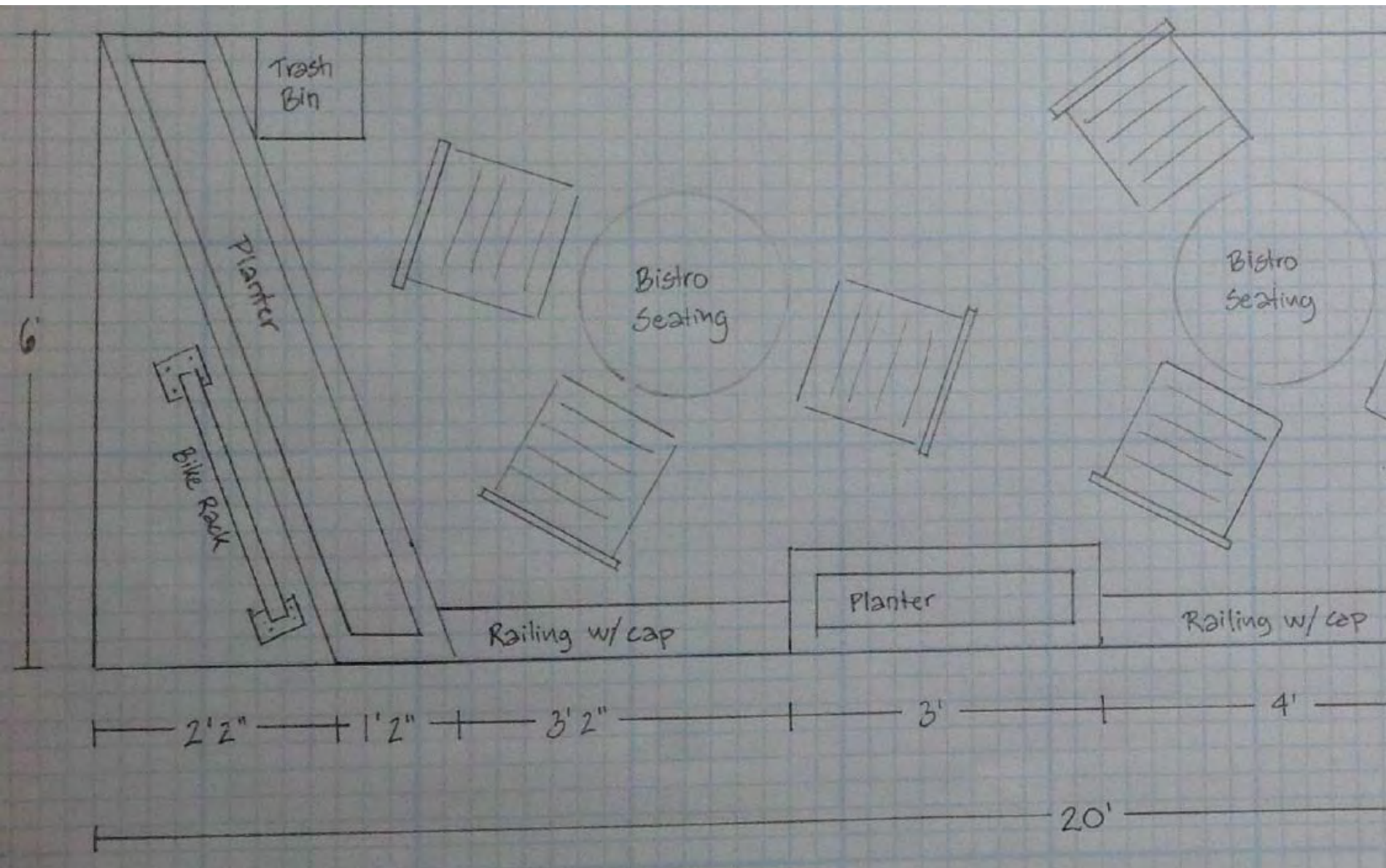

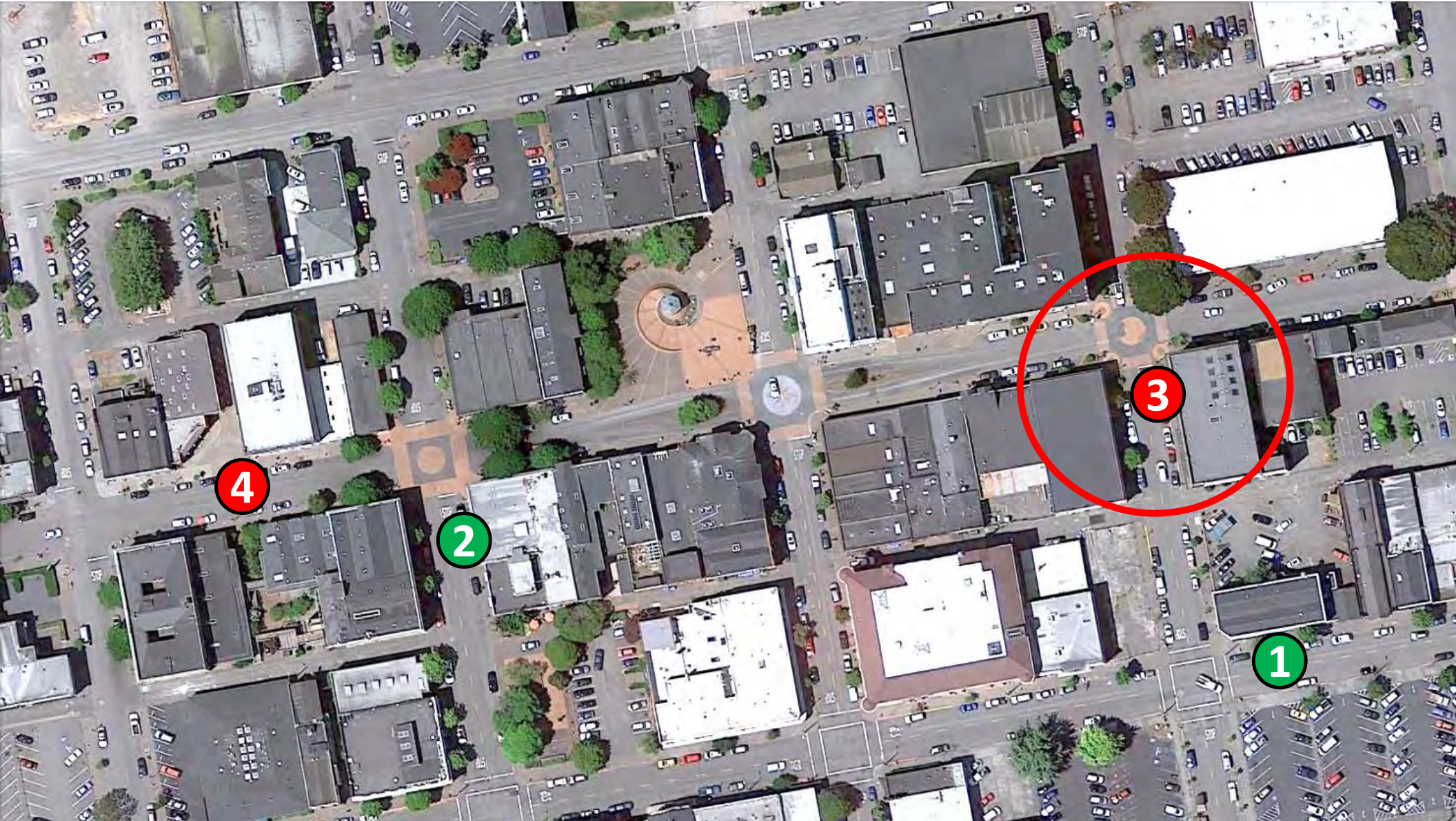

4

2

3

1

Second Street

3

Carson
Block

G Street



Taste at HBTC



ADVANTAGES

- Lettered Street
- Less sunny spot
- Connects to bulb out
- At stop sign / intersection
- Wide sidewalks
- Visible from inside business
- Promote city-wide tourism
- Landscaping
- Letters of support



G STREET PARKLET PROPOSAL



205 G St.
Eureka, CA
(707) 672-3850

12ND / STREET

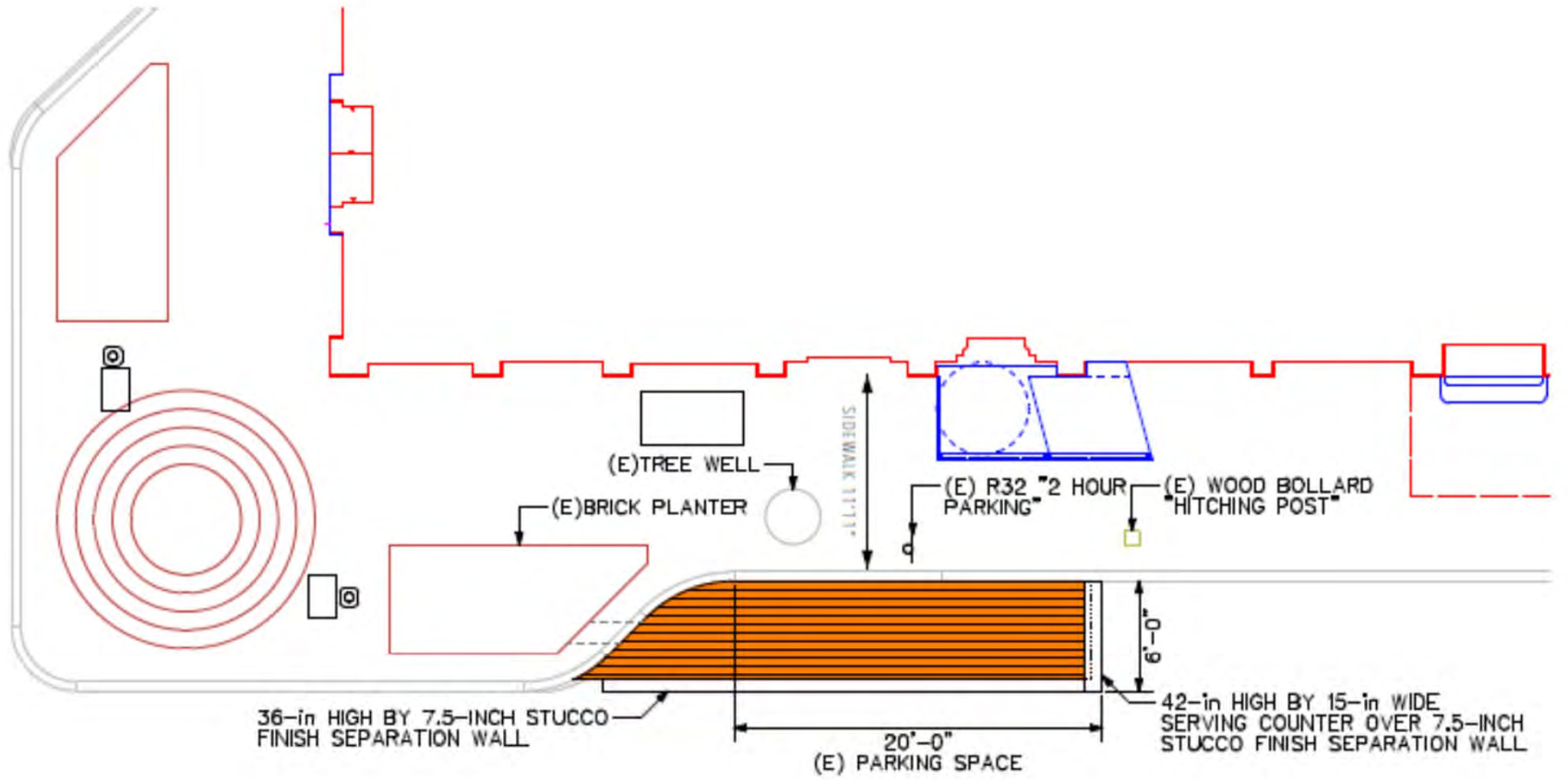

9' G STREET



Seating for 2



Seating for 4



Table end for brick planter seating



Seating for the bar top.

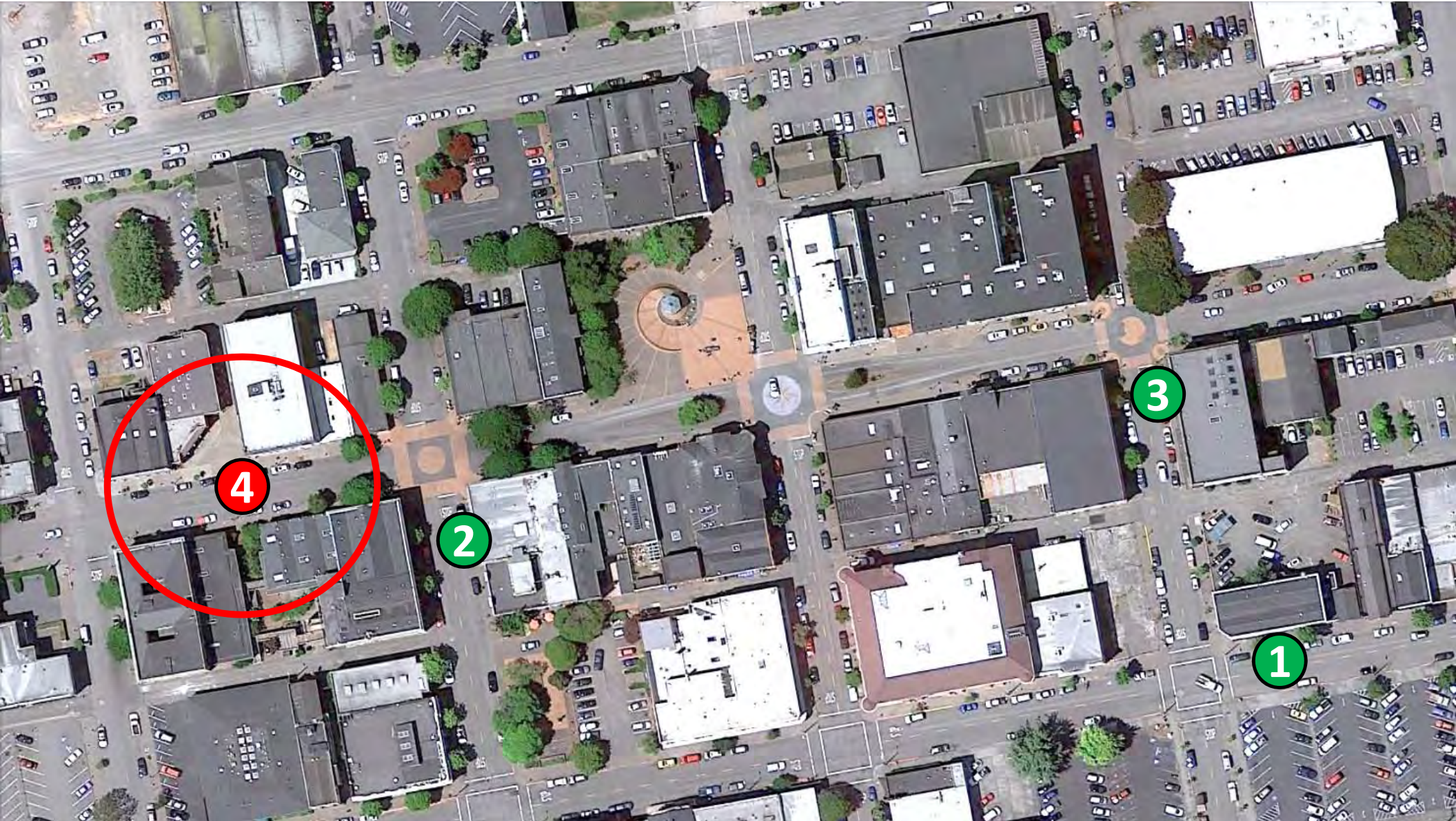

1

3

2

4



D Street

4

Second Street

Siren Song

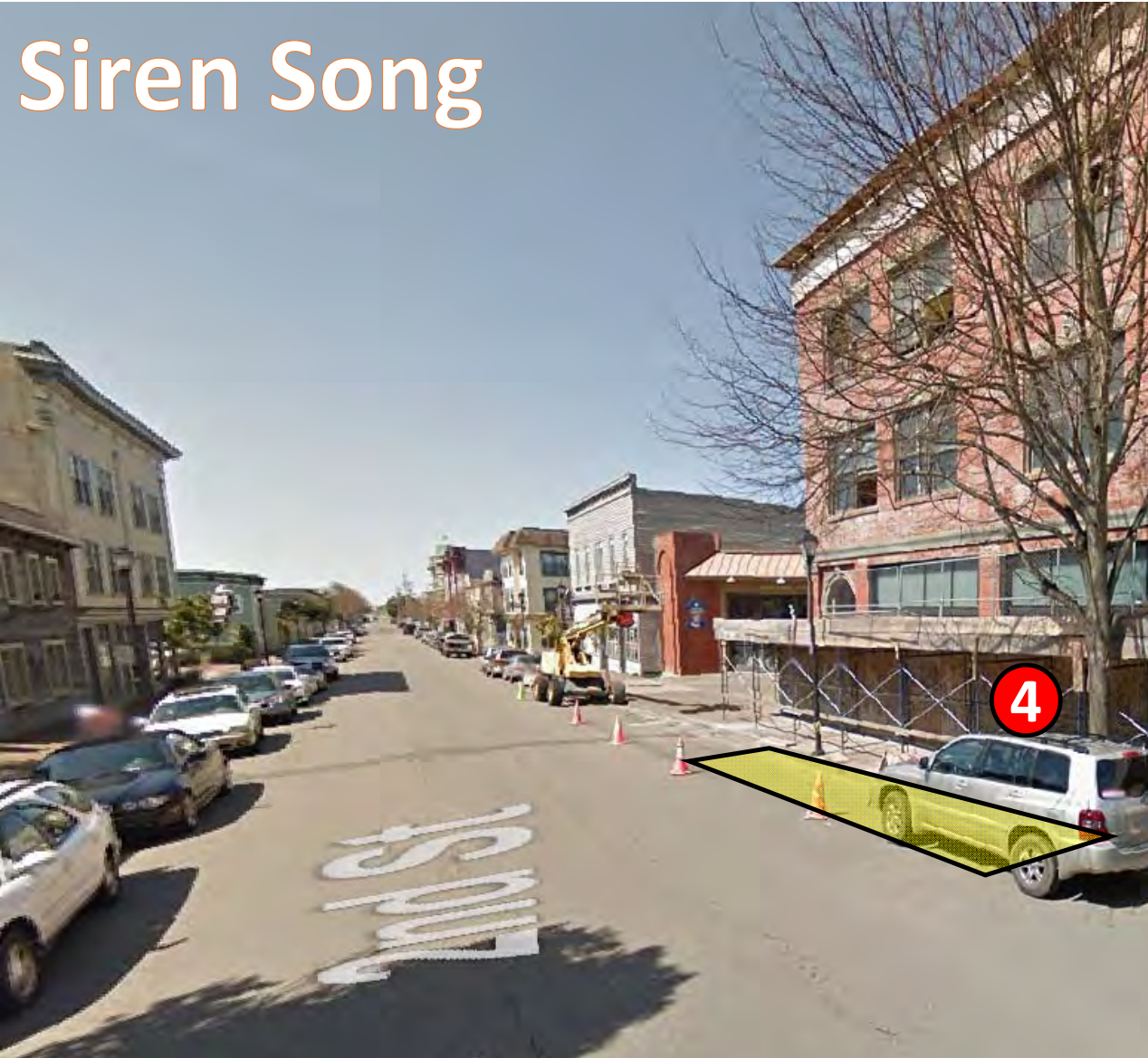

ADVANTEGES

- Numbered Street
- Sunny spot
- Midblock
- Wide sidewalks
- Lamp post
- Exclusively evening business

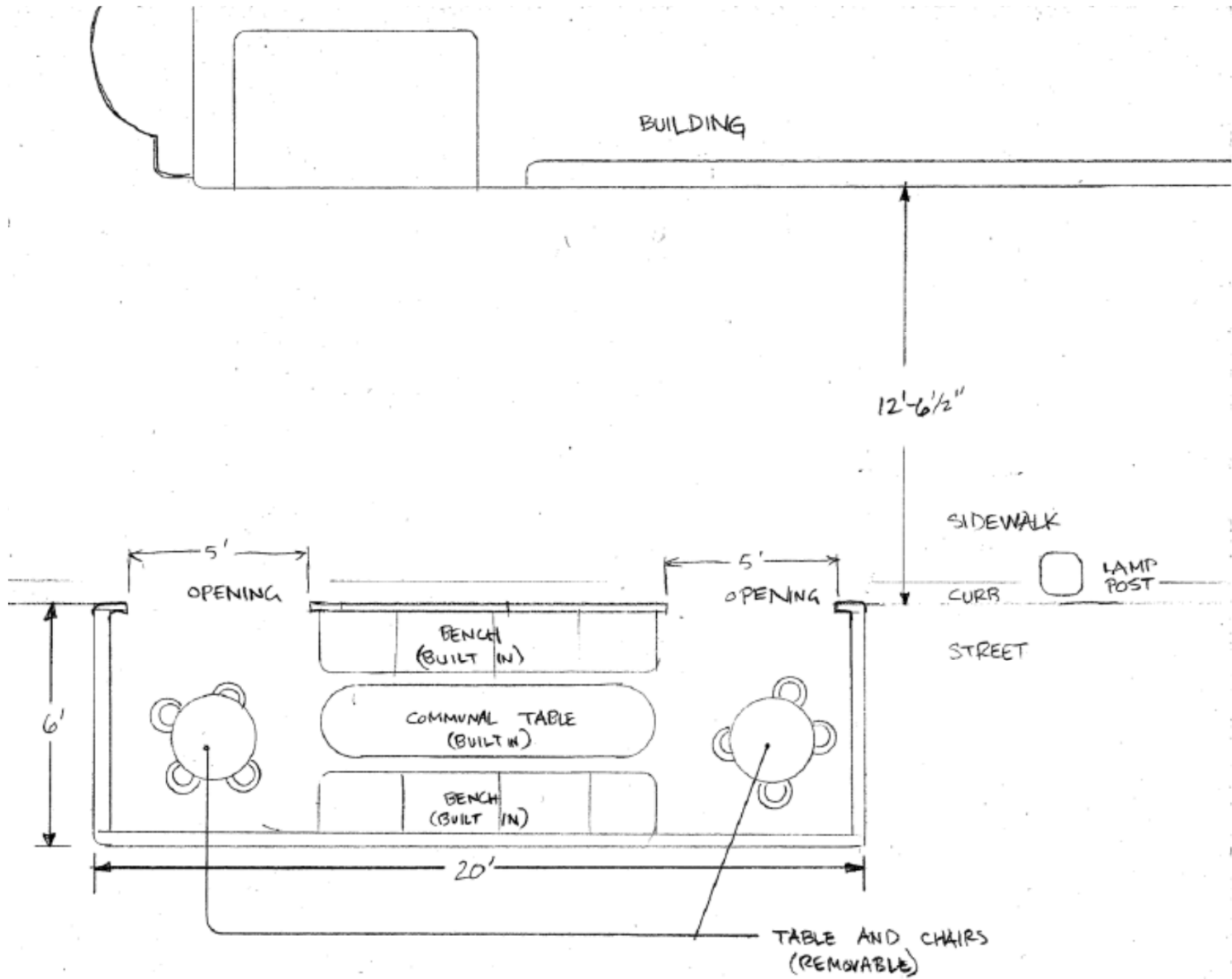

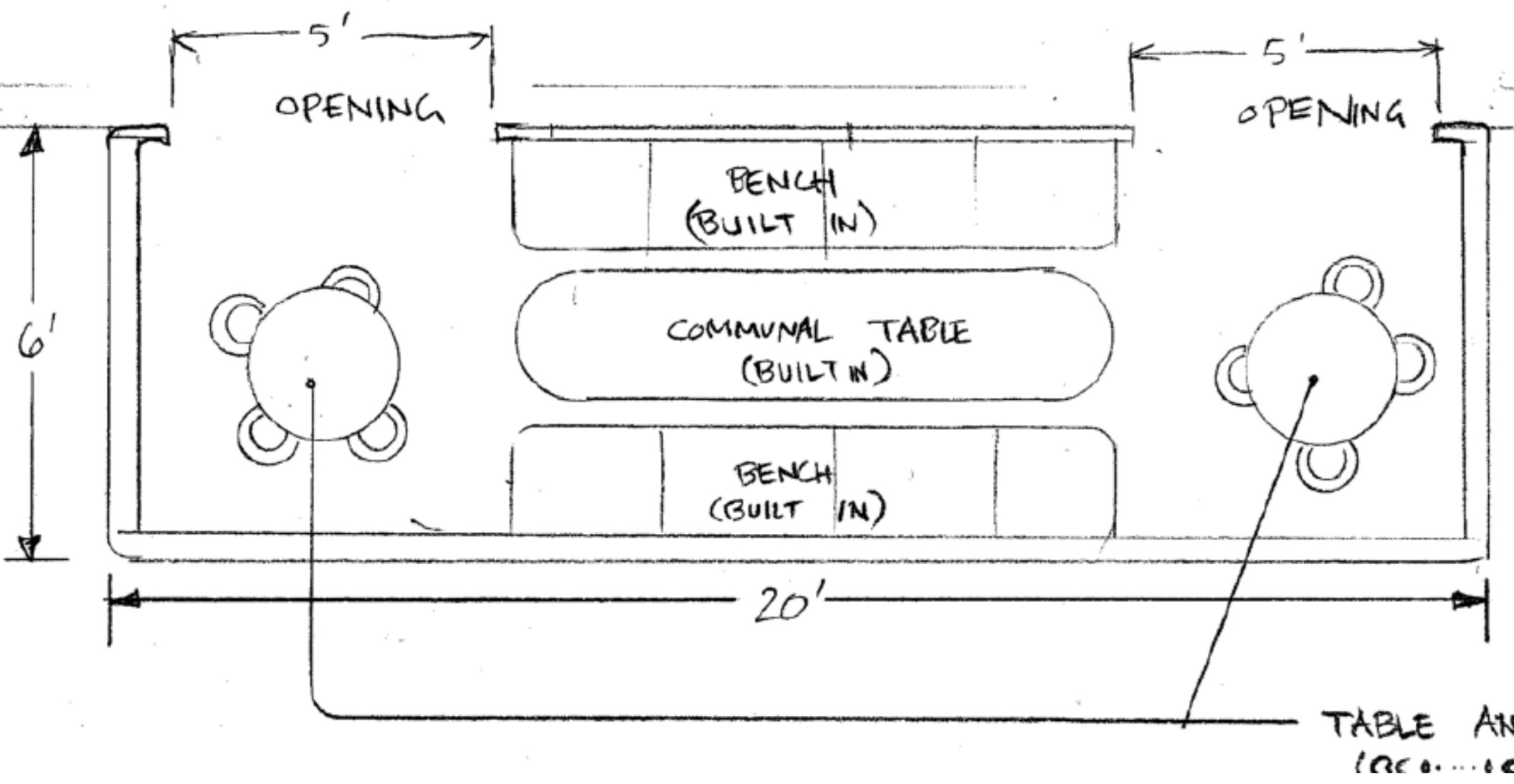

Next Steps?

Permit Criteria

- Encroachment permit
- Liability insurance
- Indemnity to City (hold harmless agreement)
- Building permit (under certain criteria)
- Design drawings
- Maintenance Plan

Design Criteria

- Dimensions and buffers (vehicular safety)
- Access and enclosure (pedestrian safety)
- Stability and security
- ADA and accessibility
- Materials
- Drainage
- Designed for easy removal/restoration

- Be attractive and creative

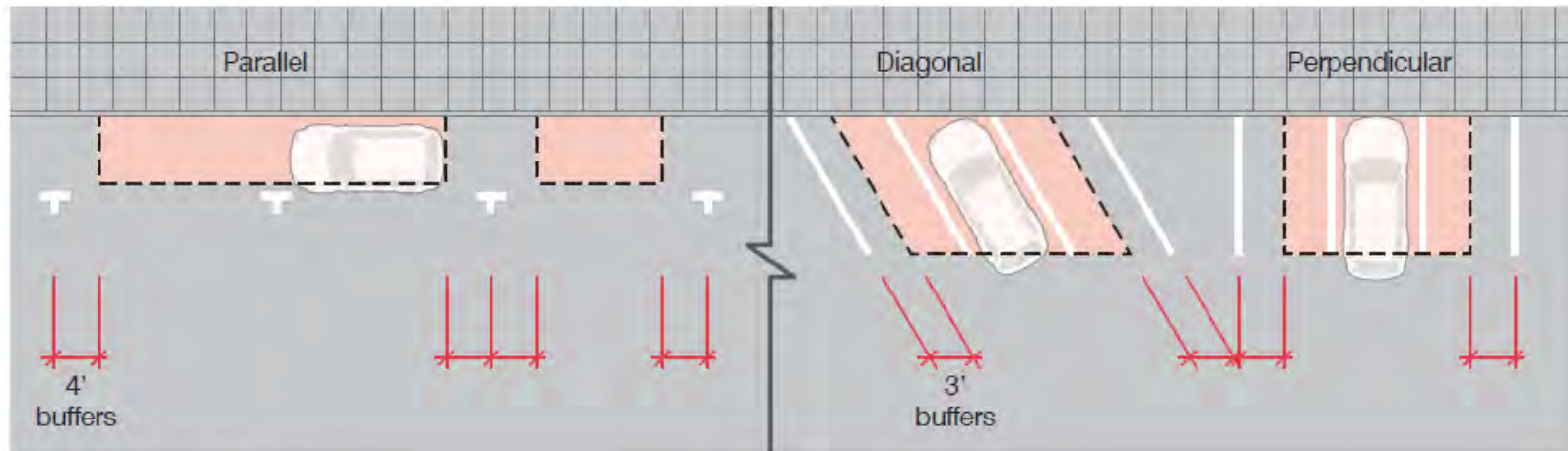

Figure 1. Parking Spaces

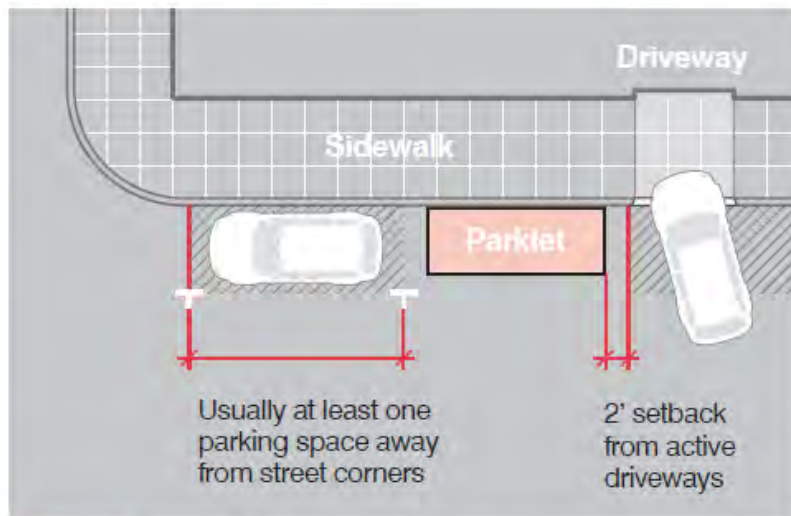

Figure 2. Corner Locations and Driveways

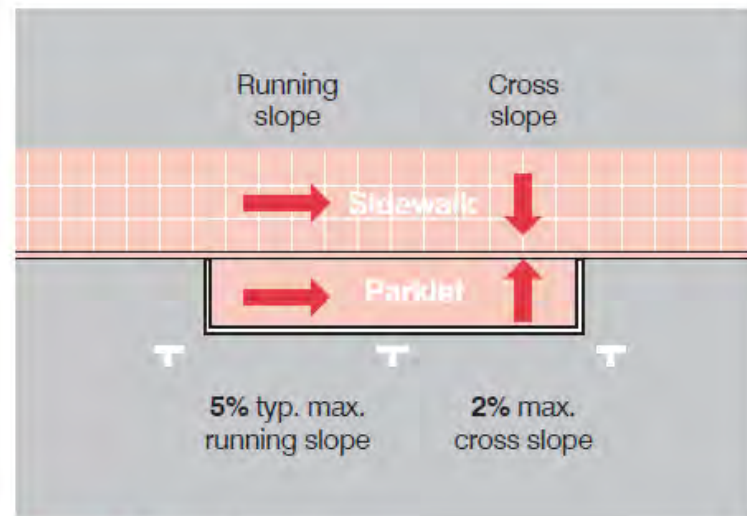
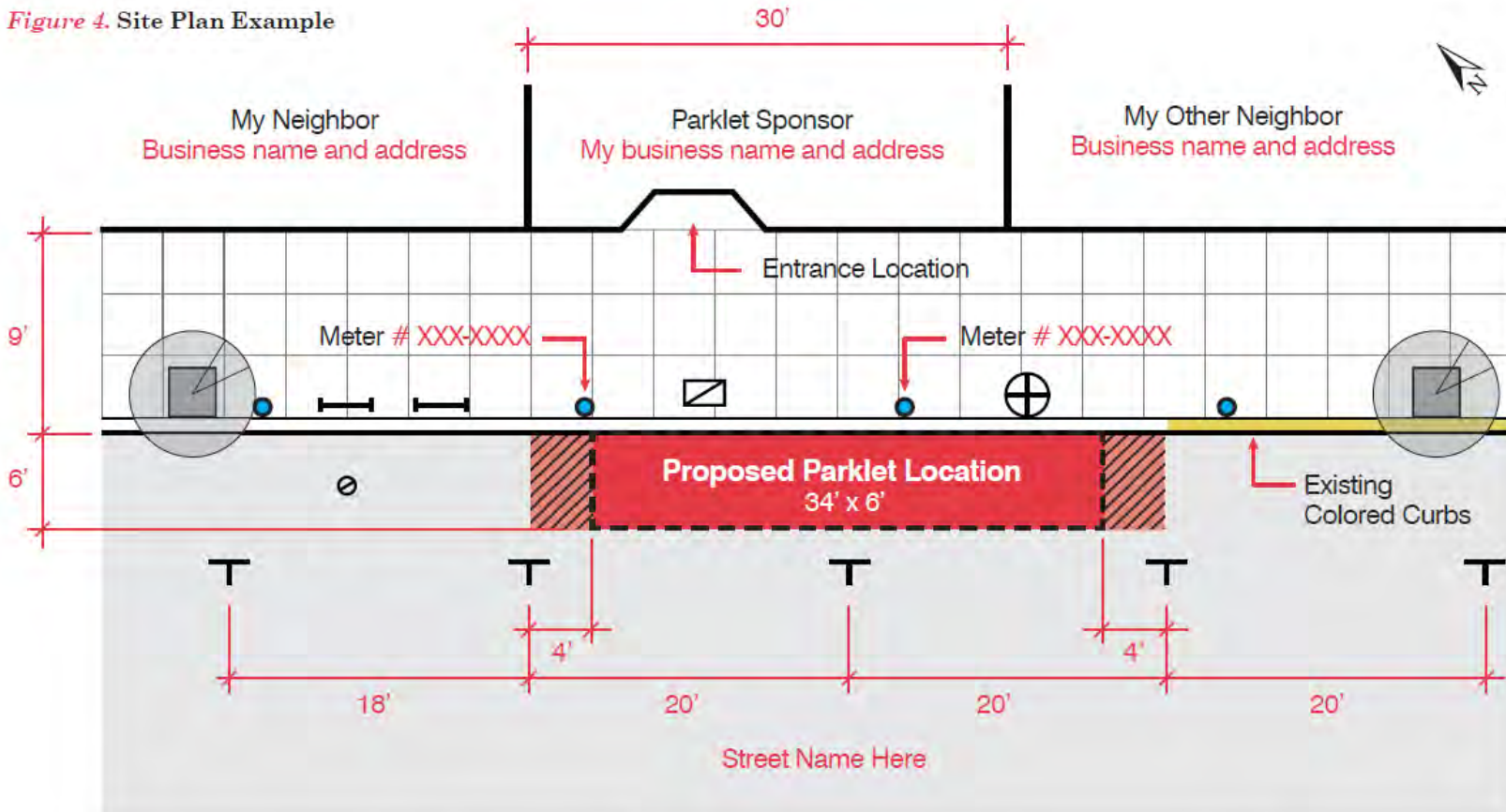

Figure 3. Street Slope



! Parklets may not be constructed over utility access panels or stormdrains.

Figure 4. Site Plan Example



- EXISTING PARKING METER
- ⊥ EXISTING BIKE RACK
- ⊞ EXISTING UTILITY (IN SIDEWALK AND IN STREET)
- T EXISTING PARKING SPACE MARKING
- ▨ 4 FT REQUIRED PARKLET SETBACK (NOT TO BE INCLUDED IN PARKLET SIZE)
- ⊕ EXISTING STREET LIGHT
- ⊙ EXISTING STREET TREE
- N NORTH ARROW

Figure 9. Drainage

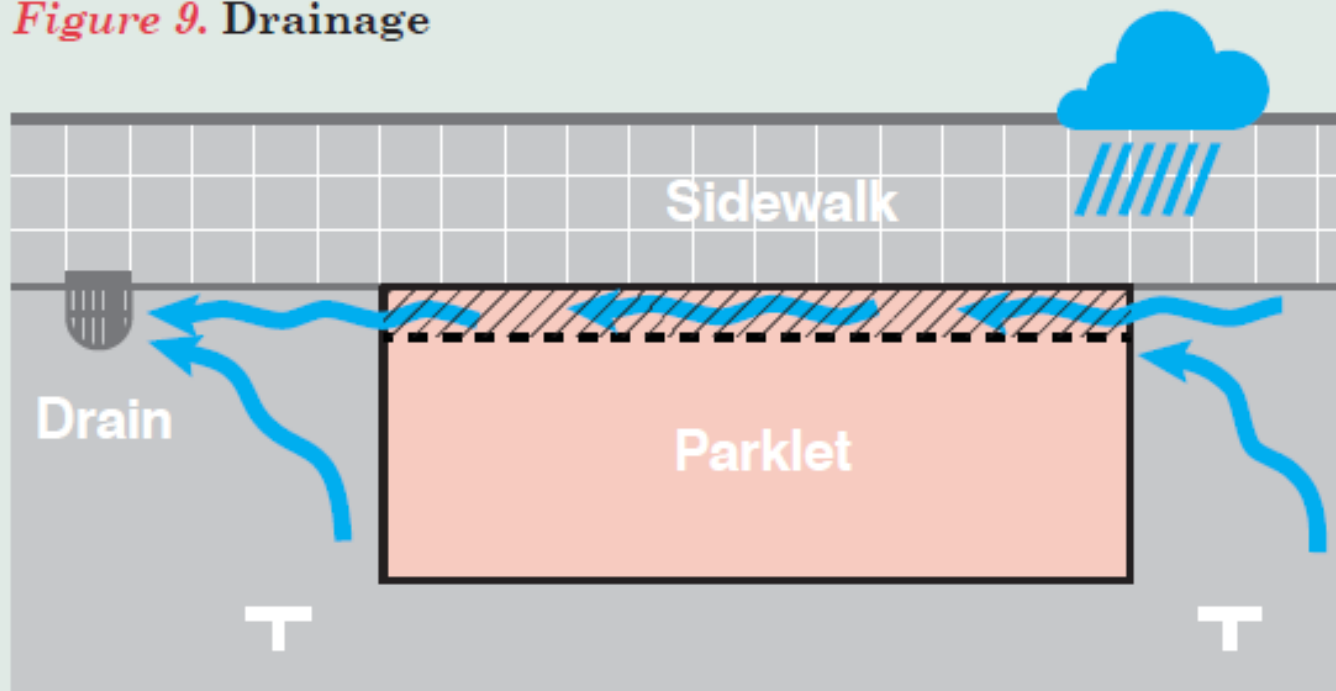

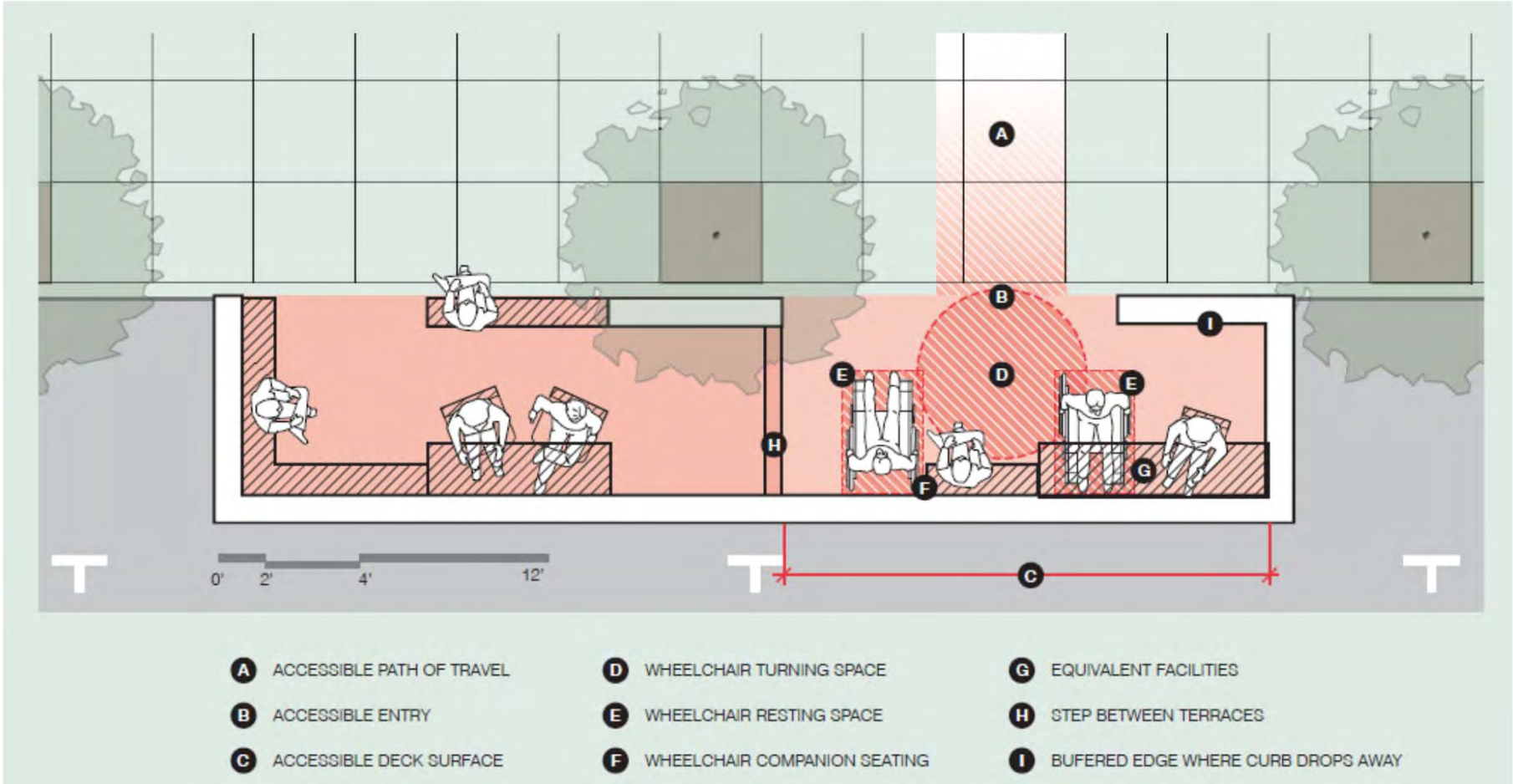

Figure 11. Edge Buffers

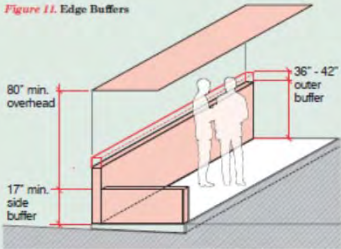
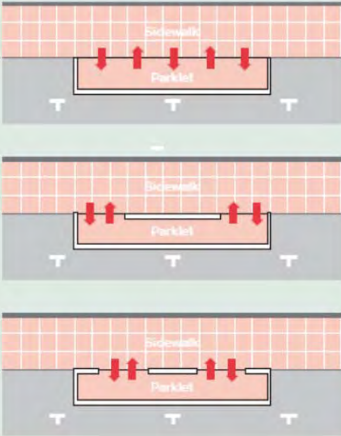

Figure 12. Extend the Sidewalk



DESIGN ELEMENT

Eureka Parklet Pilot Program



- During that time, staff will evaluate:

- Suitability of design standards
- Stormwater impacts
- Traffic impacts
- Parking impacts
- Neighborhood sentiment
- Increase in business
- Other considerations

- Provide opportunities for the following to provide feedback:

- Planning Commission
- Economic Development Commission
- Design Review Committee
- Traffic Safety Commission
- Open Space and Parks Committee
- Arts and Culture Commission

What happens after the Pilot?

- Pilot unsuccessful – terminate EPs of pilot parklets
- Pilot successful – staff presents options to Council (month 12 to 16)
 - Final design guidelines and regulations
 - Density restrictions
 - Municipal Code changes
 - Etc



Staff Recommendations

- Alter pilot program to allow four parklets for the 18-month pilot period.
- Authorize staff to begin encroachment permit process with the following businesses in order to allow each business to build a parklet in City of Eureka right-of-way: “A Taste of Bim,” “Ramones,” “Taste at Humboldt Bay Tourism Center,” and “Siren Song.”